

UBL-MT Installation Instructions v.4.1

BALL OR BOLT MOUNTING

Tools needed: 2) 7/16 - 2) 9/16" 1) 5/8" and 1) 11/16 Either sockets or open end wrenches

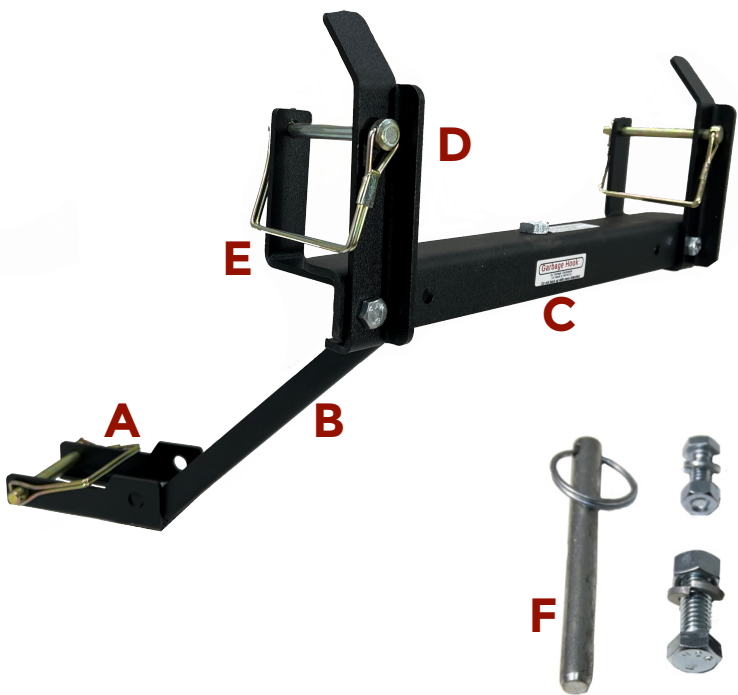

MAIN COMPONENTS

- A Receiver Ball Base
- B Lift Bracket
- C 12" Support Arm
- D 2) Mountain Hooks
- E 2) Retainer Brackets
- F 1) 3/8" retainer pin
- G 1) Under side support washer

FASTENERS

- 1) 3/8" x 1" bolt, washer & lock nut (smaller thickness)
- 1) 7/16" x 1" bolt, lock washer, washer, and nut
- 2) 1/4" x 3/4" bolts, lock washer, and nuts
- 2) 2" PTO spring clip

Scan for
UBL-MT Installation
Video >



Ball Mounted Installation: For Bolt Mounted, skip this step

Step 1- Bolt the receiver Base (A) to the Lift Bracket (B)

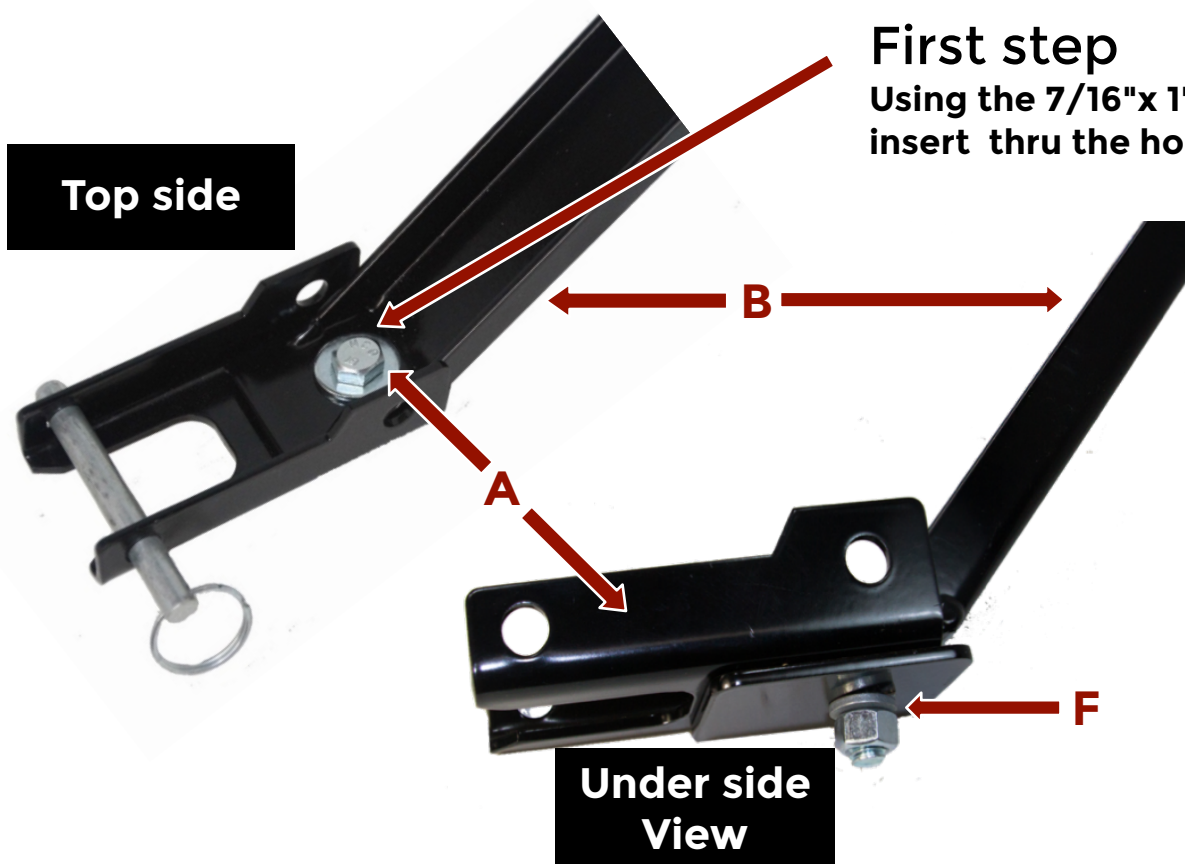

First step

Using the 7/16"x 1" bolt and 7/16" flat washer insert thru the hole at the base of the lift bracket (B)

NEXT

Slip the lift bracket (B) with the bolt & washer insert between the two flanges of the receiver base (A). Flanges will be pointed upward

From the bottom of the receiver base add the support washer (F) between the 7/16" lock washer and 7/16" nut Tighten tight , keeping support washer aligned with the receiver base

To mount to your 1-7/8" or 2" tow ball, use the 3/8 retainer pin under the rear of the ball. 2" Ball works best

NOTE: Do not leave unit attached without cans attached unit could swing into the rear tires causing damage to the unit.



Bolt Mounted Installation:

NOTE: skip step 1) if you want to use the optional bolt installation

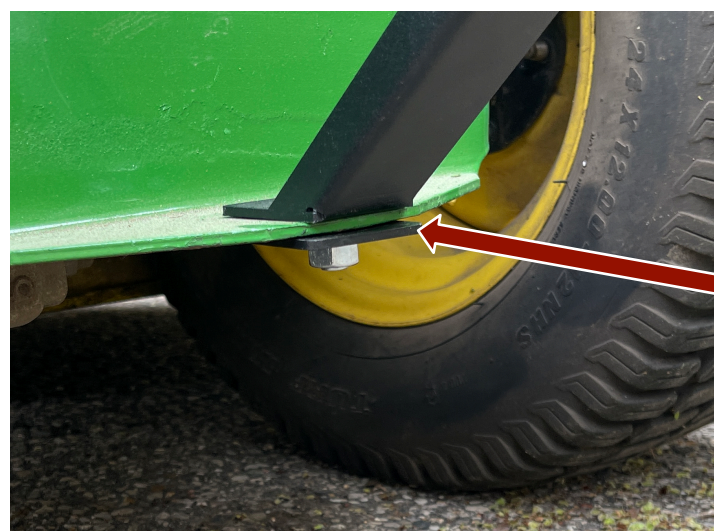

The receiver base will not be used, instead bolt the lift bracket (B) using the 7/16" x 1" bolt to install the flange of your tow vehicle still using the support washer under the tow vehicles flange and the lift bracket It is common that the hole of the tow vehicle will be large then the bolt size

Support Washer (F) under will help stiffen mounting flange
Note: Handel weight maybe reduced due to the thickness of the tow vehicles hitch flange thickness.

Step 2- Mount the 2) mountain hooks and 2) retainer bracket to the support arm

You can use the inner bolt hole that are also for fastening the two arms together along with any of the other holes at each end of the support arm. The outer holes are spaced at 1-1/2" increments to fit most of today's wheeled totes.

Install the mountain hooks using the 1/4" x 3/4" bolt, lock washers and nuts.

* Mountain hooks mount to the face of the support arm, the lower tab will wrap under the bottom edge of the support arm.

* We suggest to add on the two inner hooks the Retainer brackets. They slip behind and under the support arm.

Note: Push the retainer bracket tight to the under side so it will stay straight and inline with the hook.

* Tighten the bolts so hooks will not move.

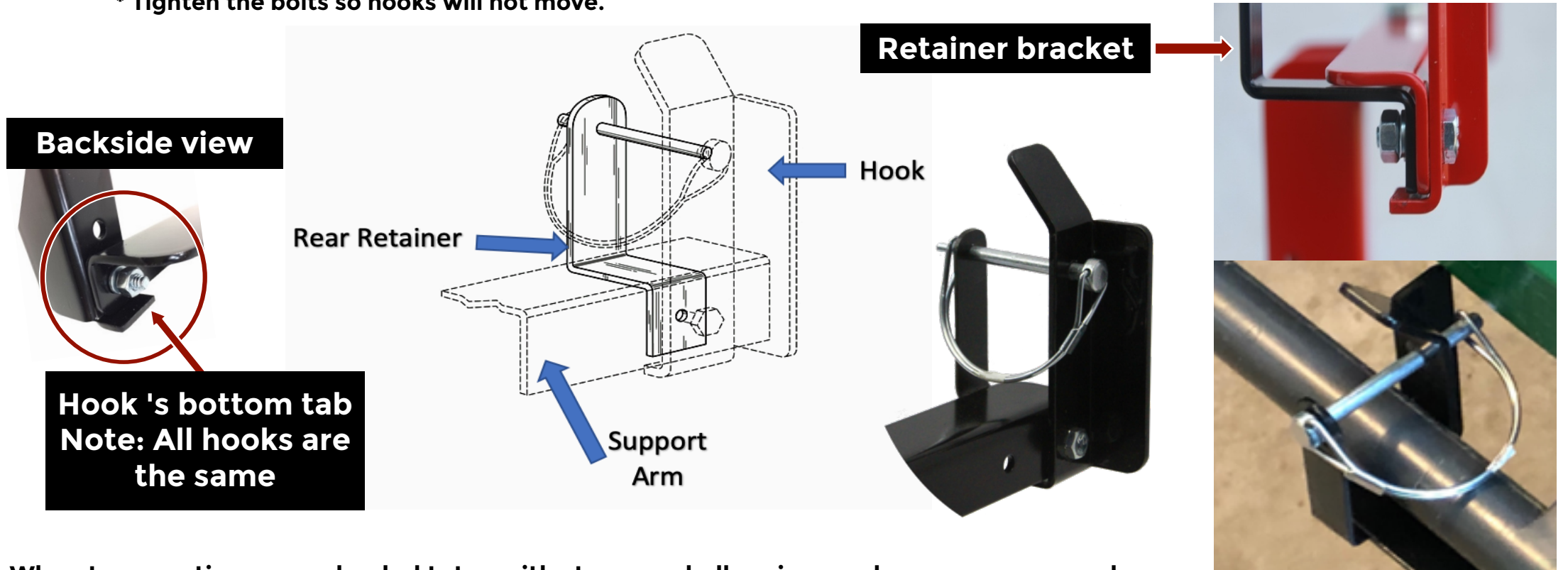

When transporting your wheeled totes with steep or challenging grades, we recommend securing the handle using all PTO spring clips that comes standard with your order.

Note: PTO spring clip can be bent outward making it easier to install

We also offer on our website ball hold down straps that are easy to apply and give extra holding if PTO clips are hard to use.



Step 3- Mount the 2) the support arm to the lift bracket

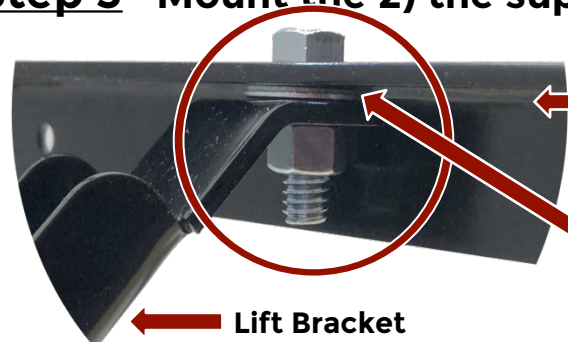

12" support Arm

Mount the 12" support arm onto the lift bracket (B). Make sure to install the 3/8" washer between the lift bracket and support arm. If you're installing the ball mounted you can tighten the nut so arm can not turn. If you are bolting the unit; tighten the nut so the arm is tight but still can pivot.

We suggest height between 14"- 21" allowing for approximately 30% of the cans weight to be resting on the support arm

Warnings:

- Keep all nuts tightened
 - Do Not exceed 15 MPH, or 75 lbs.
 - Do Not carry passengers
 - Do Not use on public roads
- Turn off vehicle and put in park before attaching your Garbage Hook.

****Garbage Hooks are designed for towing, DO NOT backup with cans attached. Damage may accrue****

Thank you for your order, as a small company we truly appreciate your business!

If you have any questions or concerns with your order, call or text us at 608-607-2788
Send an email to info@garbagecommander.com

Before leaving a negative review, contact us, we promise to make things right with you.
Help us grow by spreading the word and taking the time to leave a positive review.



Garbage Commander by:
LaMalco LLC - 2709 N. Burdick Rd. Janesville, WI. 53548
Garbage Hooks are patented and made in the USA.
Patent US 9,566,837 B1 & D888,644S